

TERMINALES TUBULARES COBRE PALA ESTRECHA

Copper narrow Palm Cable lugs
Cosses en cuivre, Pelle Etroit



Material:

SECU S/DIN 1787-73

Acabado: ESTAÑADO - TINNED

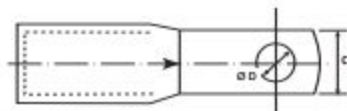
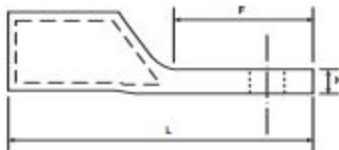

CABLE mm ²		C	D*	F	L	K	HERRAMIENTA Tool / Outil	REF.
Norm.	Flex.							
50	35	11	M 5	19	49	4	T 50 - T 95	100-11
70	50	13	M 6	21	53	4	T 95 - T 150	115 - 13
95	70	15	M 8	23	60	4,5		130 - 15
120	95	17	M 10	28	70	5,5	T 150 - PHC - HMS	155 - 17
150	120	19	M 10	30	76	6,5		170 - 19
185	150	22	M 12	30	77	6,5	PHC - HMS	190 - 22
240	185	22	M 12	30	85	8		210 - 22

* D. Máximo